

**Important Notes**

- A weather-resistive barrier should be applied to the house prior to the installation. Consult your local building code for requirements in your geographic area.
- Panels must be installed over rigid sheathing, never applied directly to studs.
- This product is not intended for roof application.
- As with all PVC panels, these V-pro™ panels expand and contract through temperature changes. Therefore:
  1. Use standard vinyl siding starter strip with V-pro™.
  2. Fasten in the center of the nailing slots.
  3. Leave approx. 1/32"(.8mm) space between the head of the fastener and the panel. Never fasten tightly.
  4. Fasten panels approximately every 16" (406mm)
  5. All siding courses must terminate into a minimum 3/4"(19mm) deep X 5/8"(16mm) wide pocket or recess behind trim. The use of factory formed J channel and/or corner posts is recommended.
  6. Leave 1/4"(6.4mm) gap in all pockets; around all openings when temperature is above 40°F and 3/8"(9.5mm) gap when below 40°F.
  7. Allow a 1/16"- 1/8"(1.6mm - 3.2mm) gap between nailing hems when seaming panels.
  8. Do not face nail the panels.
  9. Panels install left to right.

**Accessories**

**Corner Posts**

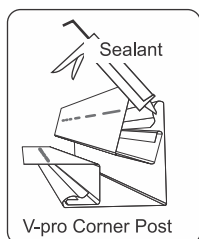

**V-pro corner posts**

- Assemble the corner for the entire height of the wall using J channel and the V-pro corners.
- Determine the location of the first course of

siding prior to the installation of the corner assembly.

- Install the post assembly so the profile will align with the wall panels fastening as shown.

*One piece vinyl siding corner posts can also be used.*

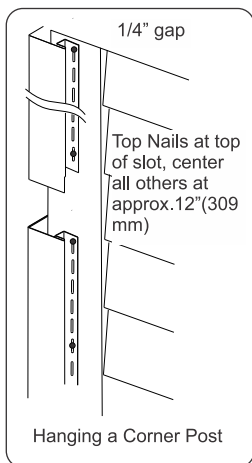

**Trimming Windows and Doors**

- J channel is used around windows and doors to receive the siding.
- Cut as shown making sure to retain a water diverting tab on any top channels.
- J channels should fit snug to the window.

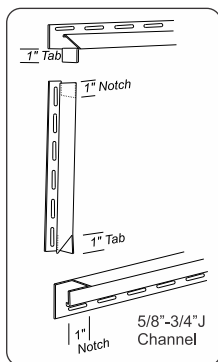

**Starter Strip**

- Starter strip must be level.
- Determine the lowest point of the wall that will be sided; from that point measure up 1/4"(6.4mm) less than the width of the starter strip. This location will be the top of the starter.
- Use a chalk line to make a straight, level reference mark.
- Align the starter on the reference mark and fasten loosely in the center of the nailing slots every 8"-12"(203mm-309mm)

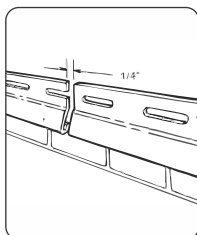

**Panel Installation**

**First Course**

- Install first panel on the left side of the wall, making sure it's fully engaged into the starter strip.
- Secure the panel.
- Continue installing the first course lapping the panel ends; leaving 1/16"-1/8"(1.6mm-3.2mm) between the nailing hems.

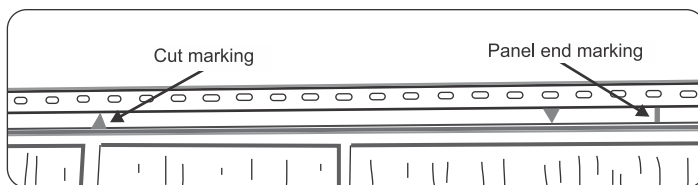

**Remaining Courses**

*The markings on the top lock of each panel are intended to help installers achieve premium aesthetics. Following this installation method will result in not having keyways line up course to course.*

- Cut left side of the panel at a cut mark, "v".
- Install this panel directly over the first course. *The bottom-right end of the panel should align just to the left of the panel alignment mark on the panel below it.*
- Continue the courses, alternating the starting panel cuts from the "Λ" mark to the "v" making sure the end of the panel aligns just left of the reference line on the panel below it.
- Start with a full panel every 5th course.

Even courses (2nd, 4th, etc.) will be cut on a "v".  
Odd courses (1st, 3rd, etc.) will be cut on a "Λ".

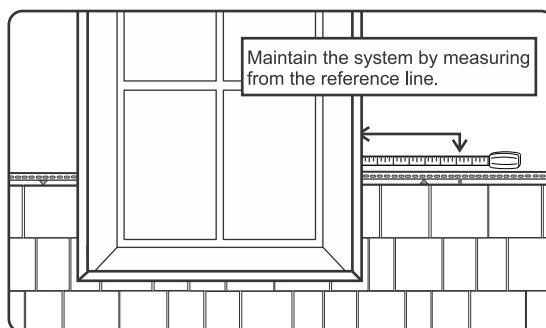

**Working around windows doors, etc.**

- When working around a window, door or obstruction that interrupts the course, determine the length of the first panel on the right of the (window) by measuring from the first panel end marking into the pocket of the receiver. This will continue the panel alignment system.

## Panel Installation continued

### Gable Installation

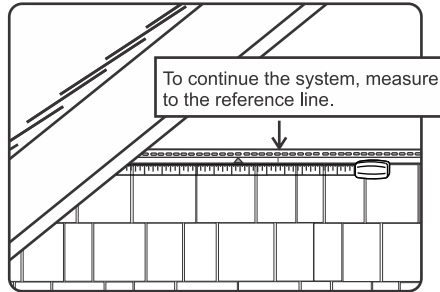

- After determining the correct angle of the roof, cut and install the first course of shingles.
- Determine the length of the starting panel of the remaining courses by measuring from the point of the angle on the panel below (from the bottom of the lock) to a panel end line.

### Top Course Installation Options

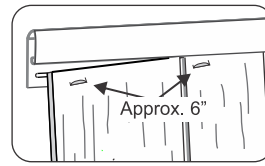

#### Finish trim:

- Using a snap lock punch, punch along the cut edge every 6" (152mm).
- Push the siding into the finish trim until the snap lugs engage holding the panel in place.

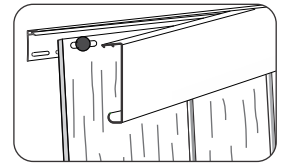

#### Back Plate/Finish Board:

- Install Back Plate along the overhang.
- Using a hole punch, punch holes along the top of the panel every 16" (406mm).
- Install the panel.
- Snap finish board into the back plate.